

# MDB (B200/B205)

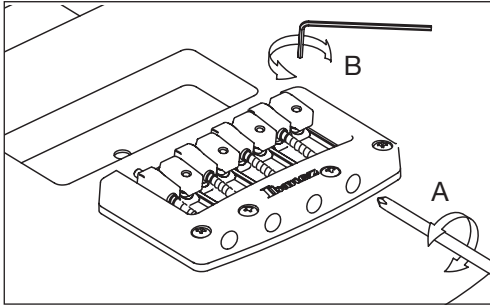

A: Intonation adjustment screw  
B: Saddle height adjustment screw  
(1.5mm hex key wrench)

## STRING REPLACEMENT

The B200/B205 bridges allow two styles of string installation.

1. Hook the ball end below the string catch at the rear of the bridge.

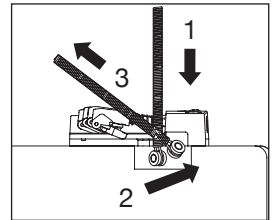

2. Hook the string catch directly below the saddle.

